

Professional Glueboard Insect Control

Please read these instructions carefully and store in a safe place for future reference.

IND35

As part of the **Insect-O-Cutor** brand of insect control products, **IND35** is an easy to service and highly effective flykiller which utilises highly effective **Synergetic** UV tubes and is designed for use with a high specification **glupac** glueboard. Constructed from coated mild steel, **IND35** can be wall or desk mounted.

CONTENTS OF PACKAGE

- 1 x IND35 flykiller
- 2 x 15W 18" Shatterproof Synergetic UV tubes
- 1 x **glupac** pheromone impregnated glueboard (Fitted)
- 3 x screws and wall plugs
- 1 x Mains cable (Type X)

WARNING - THIS APPLIANCE MUST BE EARTHED

INSECT CONTROL PRODUCTS

IND35 utilises high powered **Synergetic** tubes to attract flying insects and retains the caught insects on a glueboard for inspection or hygienic disposal. **Synergetic** tubes combine both ultraviolet light and visible green light to attract a wider range of flying insects.

WARNING

IND35 is not to be used by children or persons with reduced physical, sensory or mental capabilities, or lack of experience and knowledge, unless they have been given supervision or instruction.

Children should be supervised to ensure they do not play with the appliance.

If the mains cable is damaged it must be replaced by a specialist mains cable available from P+L Systems Ltd or your supplier.

This appliance is not suitable for barns, stables, or similar locations.

POSITIONING AND GUIDANCE FOR USING IND35

THIS UNIT IS FOR INDOOR USE ONLY.

IND35 should ideally be fixed around two meters above the ground, preferably in the darkest place within the area to be protected. Do not position the unit close to windows, skylights or other sources of light, or where it may be obscured by furniture, doors or other obstacles. Ideally, **IND35** should be visible from every part of the area to be protected.

IND35 should ideally be in operation for 24 hours a day, ensuring your premises are kept free of flying insects. Insects are most attracted to **IND35** at night when there is no competition from daylight or other light sources.

GUARANTEE

IND35 has a five year guarantee and if maintained as recommended in these instructions, should continue to work for many years. * Use of non-approved consumables may invalidate the guarantee. Ensure genuine **glupac** glueboards are used in conjunction with this product.

INSTALLATION

INSTALLATION SHOULD BE CARRIED OUT BY SERVICE PERSONNEL ONLY.

IND35 has a swing open front, which allows simple and quick access to the inside of the flykiller for installation and servicing.

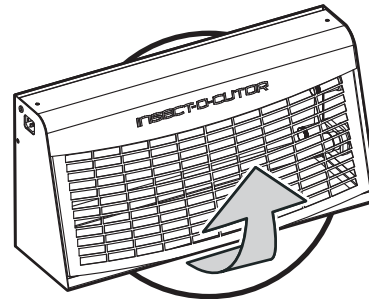

Install **IND35** by offering the product up to the wall and marking the three fixing centers. Then drill holes and fit the supplied wall plugs and screws. (For specialist wall surfaces such as plasterboard, appropriate wall plugs should be used.) Then hang the product onto the mounting screws.

Once **IND35** is installed in position, fit the **glupac** glueboard in place as described in the glueboard replacement section of this document. Use the removable mains lead and plug to connect **IND35** to an appropriate rating, as specified on the specification label found on the top of the product.

CLEANING

CLEANING SHOULD BE CARRIED OUT BY SERVICE PERSONNEL ONLY, AFTER ENSURING THAT THE UNIT IS DISCONNECTED FROM THE MAINS SUPPLY.

It is recommended that cleaning is carried out regularly when the glueboard is replaced. Once the glueboard is removed, the unit should be thoroughly wiped down with a damp cloth, removing any build up of dirt. Ensure the unit is completely dry before reconnecting it to the power supply.

GLUEBOARD REPLACEMENT

BEFORE REPLACING THE GLUEBOARD, ALWAYS ENSURE THAT THE UNIT IS DISCONNECTED FROM THE MAINS SUPPLY.

The glueboard should be replaced every month with a genuine glupac® glueboard. Use of non-approved glueboards may invalidate your guarantee. **IND35** comes supplied with discreet black glueboards with printed grids for simple insect evaluation and monitoring.

To replace the glueboard...

1. Swing the front guard open.
2. Remove the protective release paper from the new glupac® glueboard.
3. Position the top of the glupac® glueboard in position behind the two locating pins, then carefully drop the horizontal face of the board into position.

Always ensure the selected genuine glupac® glueboards are compatible with your unit, available from your pest control operator or P+L Systems Ltd.

TUBE REPLACEMENT

TUBE REPLACEMENT SHOULD BE CARRIED OUT BY SERVICE PERSONNEL ONLY, AFTER ENSURING THAT THE UNIT IS DISCONNECTED FROM THE MAINS SUPPLY.

To ensure the efficiency of **IND35** in catching flying insects, the Synergetic® tubes should be replaced annually. After twelve months the phosphor coating that emits the correct wavelength of UV light has burnt away and the UV output is diminished substantially.

To replace the UV tubes...

1. Swing the front guard open.
2. Gently rotate the tube through 90°.
3. Pull the tube forward until it becomes free from the tube holder.
4. Reverse the process with the new Synergetic® tube.
5. Dispose of the used UV tubes in conjunction with local regulations.

STARTER REPLACEMENT

STARTER REPLACEMENT SHOULD BE CARRIED OUT BY SERVICE PERSONNEL ONLY, AFTER ENSURING THAT THE UNIT IS DISCONNECTED FROM THE MAINS SUPPLY.

The starters provides an extra spark to initially light the UV tubes. Starters wear out and should be replaced at the same intervals as the UV tubes.

To replace the starters...

1. Swing the front guard open.
2. Rotate the starter anti-clockwise.
3. Pull the starter free from the unit.
4. Reverse the process with the replacement starter.

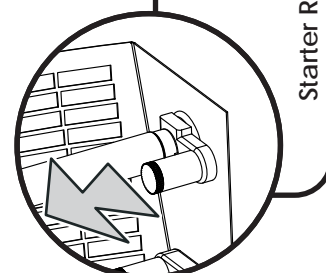
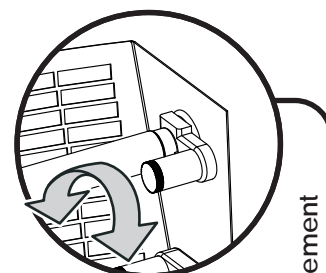
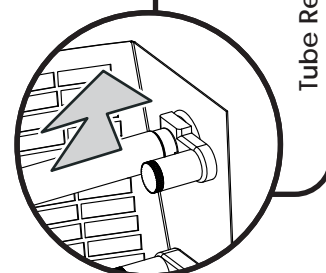
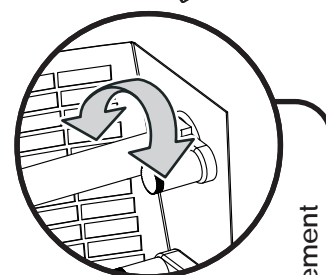
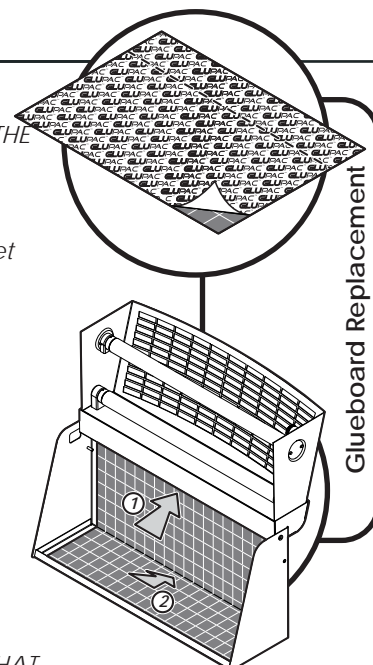

SPECIFICATION / REPLACEMENT PARTS

Unit	IND35
Voltage	230V ~ 50Hz
Dimensions(mm)	470 x 230 x 130
Coverage	80 Sq. Meters
Weight	5.0Kg
Light Output	30W
Tubes	2 x TGX15-18S
Starter	2 x I154
Glueboards (x6)	INF212 (Black)